

DROP CELESTE 4427-CEL

PROJECT PROJÉT
SPEC TYPE
NOTES

CANOPY FINISH FINI PAVILLON



BLKE

WHE

CHR

GLASS FINISH FINI VERRE



CLR

FRO

PRODUCT CHARACTERISTICS CARACTÉRISTIQUES DU PRODUIT



CONFIGURATION CONFIGURATION

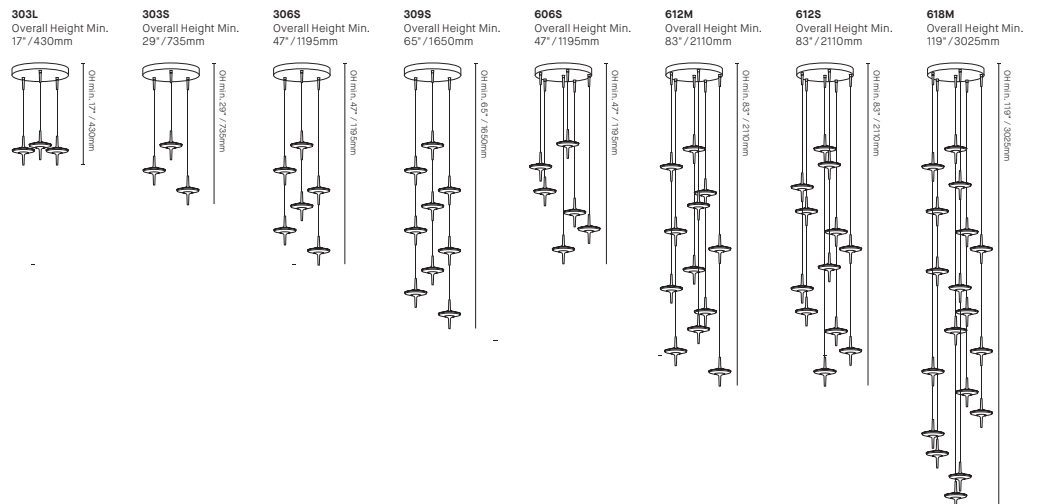

CUSTOM CONFIGURATION

For custom or large-scale configurations, simply contact the factory and we will be pleased to discuss your design requirements.

CONFIGURATION PERSONNALISÉE

Pour des configurations personnalisées ou à grande échelle, veuillez simplement contacter l'usine et nous serons heureux de discuter de vos exigences de conception.

ORDERING SPECIFICATION SPÉCIFICATION DE COMMANDE

MODEL MODÈLE	4427-CEL	4427-CEL
--------------	----------	----------

CONFIGURATION CONFIGURATION	
4427-CEL	DROP CELESTE
303L	LEVELED CLUSTER 3 CABLES, 3 HEADS MIN. HEIGHT 17"
303S	SPIRALED CLUSTER 3 CABLES, 3 HEADS MIN. HEIGHT 29"
306S	SPIRALED CLUSTER 3 CABLES, 6 HEADS MIN. HEIGHT 47"
309S	SPIRALED CLUSTER 3 CABLES, 9 HEADS MIN. HEIGHT 65"
606S	SPIRALED CLUSTER 6 CABLES, 6 HEADS MIN. HEIGHT 47"
612S	SPIRALED CLUSTER 6 CABLES, 12 HEADS MIN. HEIGHT 83"
612M	MIXED CLUSTER 6 CABLES, 12 HEADS MIN. HEIGHT 83"
618M	MIXED CLUSTER 6 CABLES, 18 HEADS MIN. HEIGHT 119"

LIGHT SOURCE SOURCE LUMINEUSE	LED
LED	REGULAR OUTPUT

COLOR TEMPERATURE TEMPÉRATURE DE COULEUR	
27	2700K
30	3000K
35	3500K
40	4000K

COLOR RENDERING INDEX (CRI) INDICE DE RENDU DE COULEUR (IRC)	90
90	90+ CRI

VOLTAGE VOLTAGE	
120V	120 VOLT
277V	277 VOLT

CONTROL OPTION OPTION DE CONTRÔLE	DV
DV	0-10V DIMMING (120V-277V)
NLTAIR2*	NLIGHT AIR CONTROL GEN 2
NLIGHT*	NLIGHT WIRED CONTROL
	*NLIGHT INTEGRATION REQUIRES A REMOTE POWER PACK (39NLAB FOR NLTAIR2 OR 39NLWB FOR NLIGHT) REFER TO NLIGHT GUIDE AND INSTALLATION SHEET FOR ALL REQUIREMENTS.

CABLE CÂBLE	C
C	BLACK CABLE, CONNECTOR MOUNTED, NOT FIELD ADJUSTABLE

OVERALL HEIGHT HAUTEUR HORS TOUT	**
**	CUSTOM OVERALL HEIGHT (PLEASE SPECIFY)
	OVERALL HEIGHT MEASURED FROM CEILING TO BOTTOM OF FIXTURE
	CONFIGURATION PATTERN IS SET, ONLY UPPER CABLES ARE INFLUENCED BY OVERALL HEIGHT
	PLEASE REFER TO CONFIGURATION'S MINIMUM HEIGHT FOR SPECIFICATION

CANOPY FINISH FINI PAVILLON	
BLKE	BLACK FINE TEXTURE
WHE	WHITE FINE TEXTURE
CHR	CHROME

HEAD FINISH FINI TÊTE	BLKE
BLKE	BLACK FINE TEXTURE

GLASS FINISH FINI VERRE	
CLR	CLEAR GLASS
FRO	FROSTED GLASS

ACCESSORY ACCESSOIRE	
ALL ACCESSORIES ARE AVAILABLE FOR ADVANCE SHIPPING	
39NLAB*	NLIGHT AIR GEN 2 REMOTE CONTROL BOX
39NLWB*	NLIGHT WIRED REMOTE CONTROL BOX
	*FOR CHICAGO PLENUM INSTALLATION, PLEASE CONTACT YOUR EUREKA REPRESENTATIVE.

CELESTE

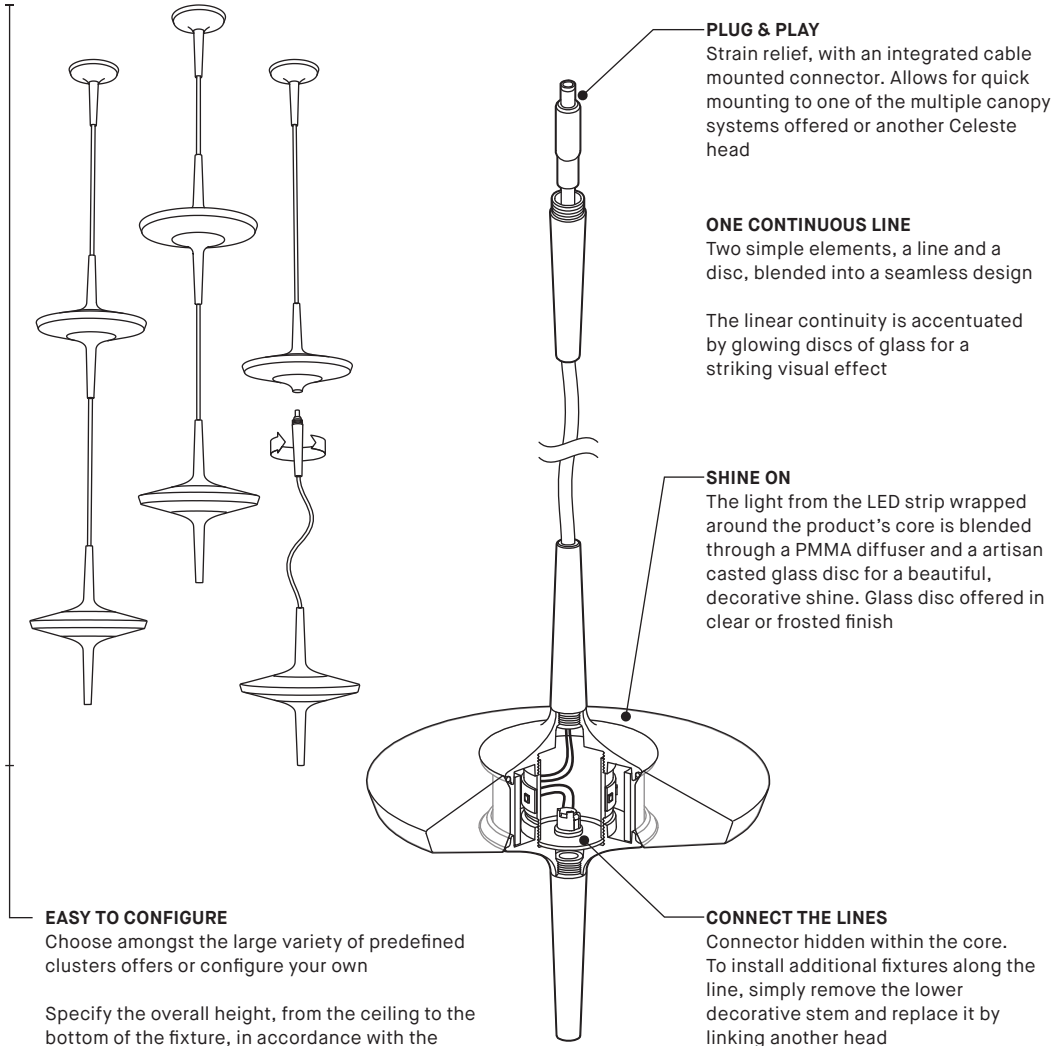

EASY TO CONFIGURE

Choose amongst the large variety of predefined clusters offers or configure your own

Specify the overall height, from the ceiling to the bottom of the fixture, in accordance with the configuration's minimum height and we'll take care of the rest

PLUG & PLAY

Strain relief, with an integrated cable mounted connector. Allows for quick mounting to one of the multiple canopy systems offered or another Celeste head

ONE CONTINUOUS LINE

Two simple elements, a line and a disc, blended into a seamless design

The linear continuity is accentuated by glowing discs of glass for a striking visual effect

SHINE ON

The light from the LED strip wrapped around the product's core is blended through a PMMA diffuser and a artisan casted glass disc for a beautiful, decorative shine. Glass disc offered in clear or frosted finish

CONNECT THE LINES

Connector hidden within the core. To install additional fixtures along the line, simply remove the lower decorative stem and replace it by linking another head

CELESTE SYSTEMS

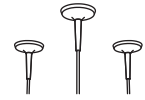

DROPLET CELESTE 2447-CEL

Remote junction box option
Offered with 1, 3, 5, or 6 connector mounted mini canopies



DROPLET CELESTE 2448-CEL

Octagonal junction box mounting
Offered with 1 connector mounted mini canopy and decorative plate covering the junction box

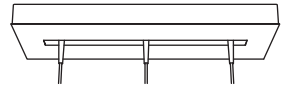

ARRAY CELESTE 4425-CEL

Offered with 3 or 5 connectors

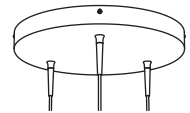

DROP CELESTE 4427-CEL

Offered with 3 or 6 connectors



CELESTE 4010-CEL

Extra head accessory light source
Requires a Celeste system (sold separately)

PRODUCT SPECIFICATION **XXX-CEL-CLR** **XXX-CEL-FRO**

PERFORMANCE		
WATTAGE PER HEAD	3.8W	3.8W
DELIVERED LUMENS PER HEAD (4000K)	200 LM	235LM
OTHER INFORMATION		
LUMINAIRE'S WEIGHT	2.2LBS / 1KG	2.2LBS / 1KG
MAXIMUM HEADS PER CABLE	6 HEADS	6 HEADS
MAXIMUM HEADS ON SYSTEM	20 HEADS	20 HEADS

EFFICACY MULTIPLIERS

CRI	CCT	FACTOR
80	4000K	N/A
80	3500K	N/A
80	3000K	N/A
80	2700K	N/A
90	4000K	1.00
90	3500K	0.95
90	3000K	0.90
90	2700K	0.87

LIGHT DISTRIBUTION

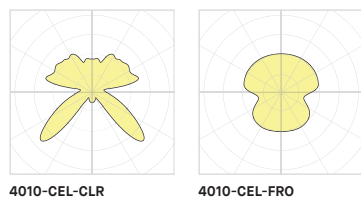

4010-CEL-CLR

4010-CEL-FRO



Visit our website for warranty terms and conditions.



TECHNICAL DATA

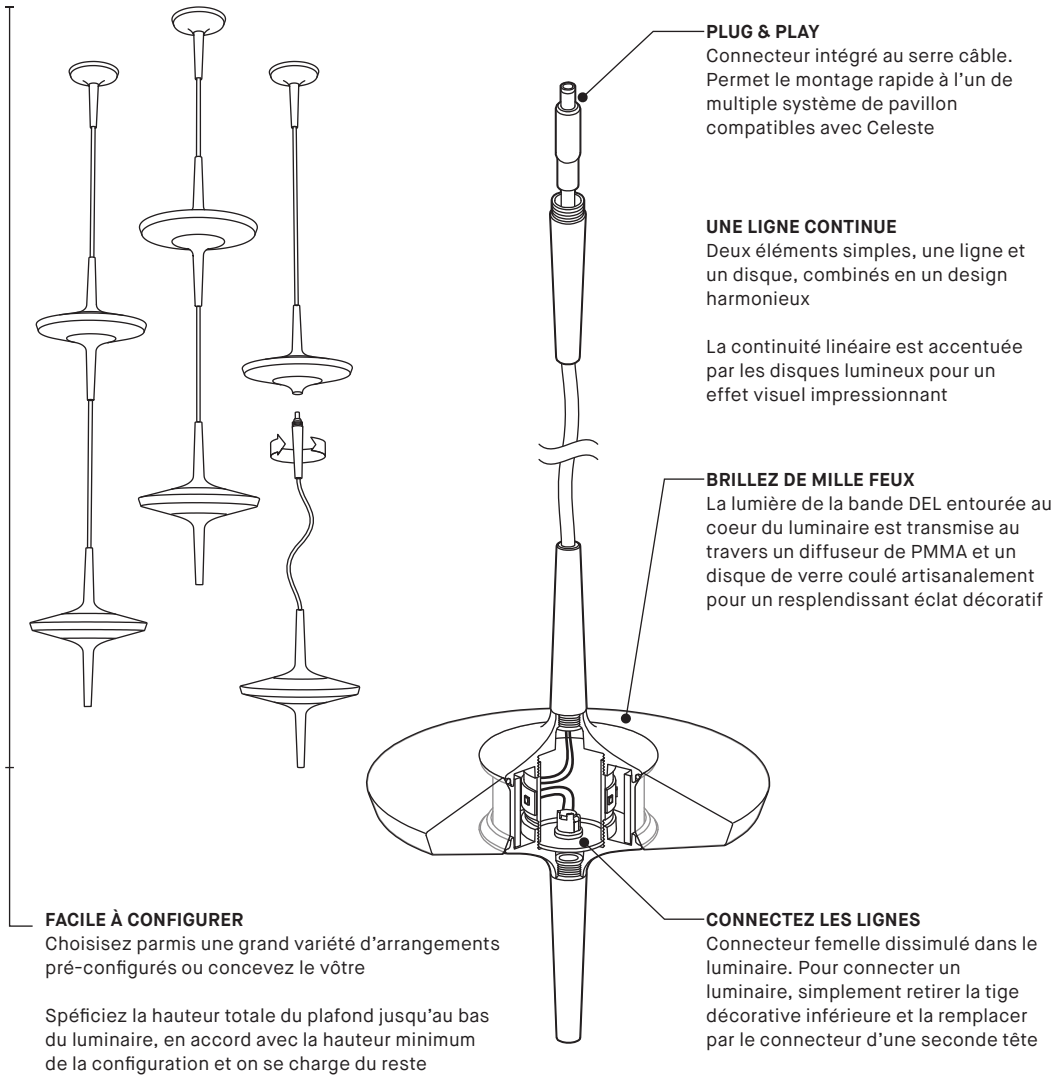

SYSTÈMES CELESTE

DROPLET CELESTE 2447-CEL
Option avec boîtes de jonction éloignée
Offert avec 1, 3, 5, ou 6 mini pavillons munis de connecteurs

DROPLET CELESTE 2448-CEL
Montage sur boîte de jonction octogonale
Offert avec 1 mini pavillon muni d'un connecteur et une plaque décorative couvrant la boîte de jonction

ARRAY CELESTE 4425-CEL
Offert avec 3 ou 5 connecteurs

DROP CELESTE 4427-CEL
Offert avec 3 ou 6 connecteurs

CELESTE 4010-CEL
Accessoire tête lumineuse supplémentaire
Requiert un système Celeste (vendu séparément)

SPÉCIFICATION PRODUIT

	XXX-CEL-CLR	XXX-CEL-FRO
PERFORMANCE		
PUISSANCE PAR TÊTE	3.8W	3.8W
LUMENS RÉELS PAR TÊTE (4000K)	200 LM	235LM
AUTRES INFORMATION		
POIDS PAR TÊTE	2.2LBS / 1KG	2.2LBS / 1KG
MAXIMUM DE TÊTES PAR CABLE	6 TÊTES	6 TÊTES
MAXIMUM DE TÊTES SUR LE SYSTÈME	20 TÊTES	20 TÊTES

FACTEUR D'EFFICACITÉ

IRC	CCT	FACTEUR
80	4000K	N/A
80	3500K	N/A
80	3000K	N/A
80	2700K	N/A
90	4000K	1.00
90	3500K	0.95
90	3000K	0.90
90	2700K	0.87

LIGHT DISTRIBUTION

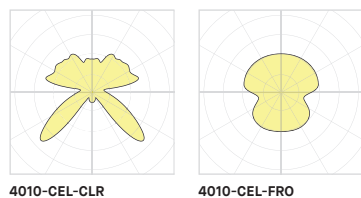

Visitez notre site Web pour les termes et conditions.