

# SKIRT 4255-UCR

PROJECT PROJÉT
SPEC TYPE
NOTES



## OVERALL HEIGHT HAUTEUR HORS TOUT

LIGHT SOURCE	INC-LED TRACK 1 CIRCUIT	LED DIM TRACK 1 CIRCUIT	INC	LED DIM -8W 277V
MOUNTING	2734B	2734F	2401E	2403G
CABLE	70.35"	71.75"	71.00"	71.50"

## MOUNTING OPTIONS OPTIONS DE MONTAGE

2734B	2734F	2401E	2403G
1.46" x 1.36" 37 x 35mm	7.25" x 1.70" 37 x 35mm	Ø4.50" x 1.00" Ø114 x 25mm	Ø4.50" x 1.50" Ø114 x 38mm

\* OVERALL HEIGHT DOES NOT INCLUDE TRACK THICKNESS

## STEM OR CABLE OPTIONS OPTIONS DE TIGE OU CABLE

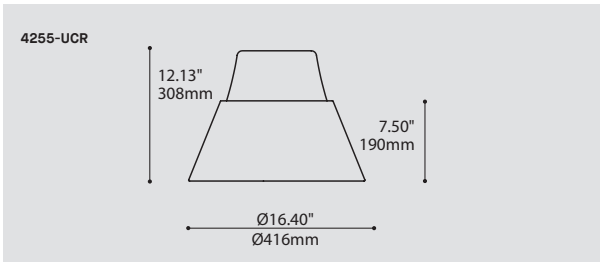
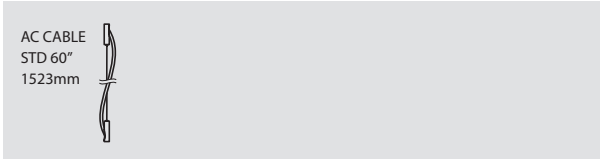

ORDERING SPECIFICATION	SPÉCIFICATION DE COMMANDE	CODE
<b>MODEL MODÈLE</b>	4255-UCR SKIRT	4255-UCR
<b>LIGHT SOURCE SOURCE LUMINEUSE</b>	(WATTAGE, LAMP TYPE, LAMP FORM, BASE TYPE, OTHER INFO)	
<b>INC.100</b>	100W, INC, A19 / HAL T10, MEDIUM BASE (120V ONLY)	
<b>LED.4</b>	4W, LED	
<b>LED.8</b>	8W, LED	
<b>LED.18</b>	18W, LED	
<b>COLOR TEMPERATURE TEMPÉRATURE DE COULEUR</b>	FOR LED ONLY	
<b>27</b>	2700K	
<b>30</b>	3000K	
<b>35</b>	3500K	
<b>40*</b>	4000K *LONGER LEAD TIME MAY APPLY. PLEASE CONTACT YOUR EUREKA REPRESENTATIVE	
<b>COLOR RENDERING INDEX (CRI) INDICE DE RENDU DE COULEUR (IRC)</b>	90+ CRI FOR LED ONLY - MANDATORY	
<b>VOLTAGE VOLTAGE</b>	120V 120 VOLT 277V* 277 VOLT	
<b>DIMMING OPTION OPTION DE GRADATION</b>	FOR LED ONLY <b>DV*</b> 0-10V DIMMING (120-277V) <b>DP</b> PHASE DIMMING (120V ONLY) LED DIMMING DRIVER IS STANDARD FOR LED.18. PLEASE SPECIFY YOUR DIMMING TYPE. *NOT AVAILABLE WITH A TRACK ADAPTOR	
<b>CABLE CABLE</b>	AC AIRCRAFT MOUNTING & CLEAR CABLE, FIELD ADJUSTABLE	AC
<b>CABLE LENGTH LONGUEUR DE CABLE</b>	<b>60</b> 60" AIRCRAFT CABLE (STD LENGTH) <b>**</b> CUSTOM AIRCRAFT CABLE LENGTH (PLEASE SPECIFY) FOR OVERALL LENGTH PLEASE CONTACT YOUR EUREKA REPRESENTATIVE.	
<b>MOUNTING MONTAGE</b>	<b>RC</b> ROUND CANOPY / PAVILLON ROND FOR LED 18W: 0.50" CANOPY (2401C) FOR INC & LED: 1.00" CANOPY (2401E) FOR DIMMING LED 4W AND 8W & LED 8W 277V: 1.75" CANOPY (2403G) TRACK ADAPTOR / ADAPTATEUR DE RAIL* <b>TA1</b> 1 CIRCUIT INC, LED NON-DIMMING (4W & 8W) & LED (18W) 120V ADAPTOR (2734B) LED DIMMING (4W & 8W) 120V ADAPTOR (2734F)	
<b>TRACK ADAPTOR FINISH FINI ADAPTATEUR DE RAIL (A)</b>	<b>WH</b> WHITE <b>BLK</b> BLACK <b>M G</b> METALLIC GRAY (A) FILL IN IF A TRACK ADAPTOR IS SELECTED, OTHERWISE LEAVE EMPTY	
<b>STRUCTURE FINISH FINI STRUCTURE (B)</b>	<b>BLK</b> BLACK <b>WH</b> WHITE INTERNAL PARABOLIC REFLECTOR SUPPLIED AS WHITE ONLY. (B) INCLUDE CANOPY FINISH IF A CANOPY IS SELECTED	
<b>DIFFUSER FINISH FINI DIFFUSEUR</b>	<b>CFR</b> CLEAR / FROSTED	CFR

## PRODUCT CHARACTERISTICS CARACTÉRISTIQUES DU PRODUIT



**DESIGN:** Beautiful organic glass direct/indirect pendant with a floating conic skirt shape.  
**STRUCTURE:** Die-formed steel canopy and fittings with white parabolic interior reflector.  
**DIFFUSER:** Hand blown clear glass with a precisely aligned frosted section and black or white die-spun aluminum shade.  
**CERTIFIED:** c-CSA-us

# ANATOMY

BIM

DIM

IES

LED

# SKIRT

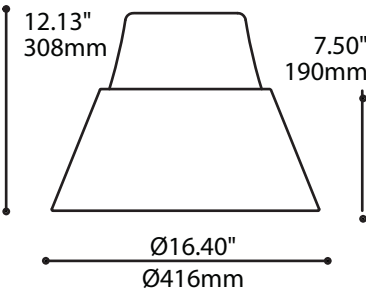
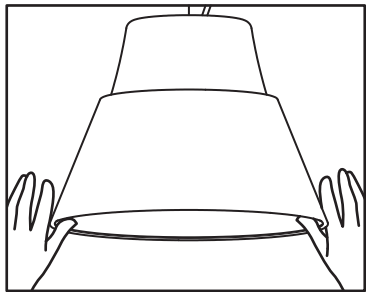
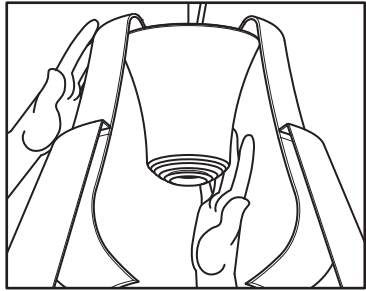
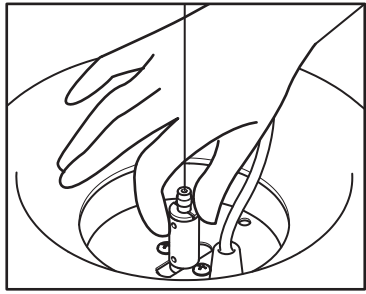

**PARABOLIC REFLECTOR**  
White powder coated spun  
16Ga aluminium sheet

**SINGLE AIRCRAFT CABLE**  
Adjustable on site

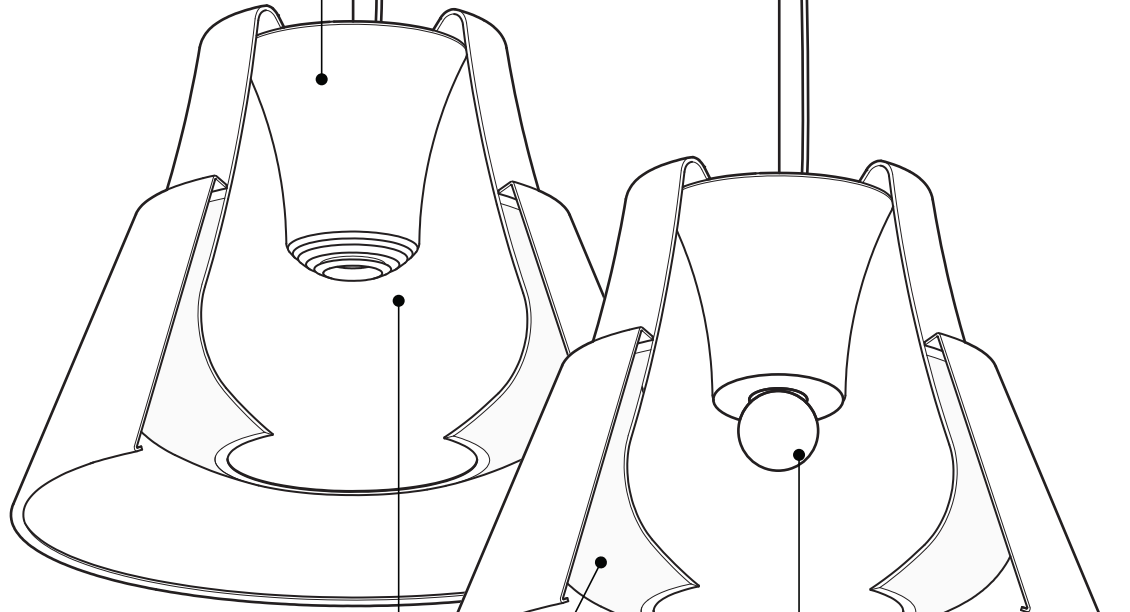

**4&8W LED VERSIONS**  
Machined aluminium heatsink  
with integrated driver

**FROST BOTTOM SECTION**  
Sandblasted to protect  
from the glare

**18W LED VERSIONS (H0)**  
LED COB with high efficiency  
spherical diffuser

**SPUN ALUMINIUM SHADE**  
The severe geometrical shape contrast  
with the soft curves of the glass

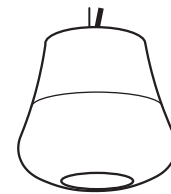

4255-UFL (BARE)



4255-UCR (SKIRT)

## SPECIFICATIONS

	LED 4W	LED 8W	LED 18W
LIGHT SOURCE	4x high power LED (total 4.7W)	4x high power LED (total 9.8W)	1x COB LED (total 18W)
DELIVERED LUMENS	478lm (4000K)	875lm (4000K)	1304lm (4000K)
CRI	84 CRI (typical)		
DRIVER	CC 350mA	CC 700mA	CC 500mA
DIMMING	Phase dimming (DP) or 0-10V dimming (DV)		
LM-79	On request		
WARRANTY	5 years		On request

## SPECIFICATIONS

	INCANDESCENT
LIGHT SOURCE	A19, T10 100W
DIMMING	Always
VOLTAGE	120V



225 de Liège Ouest, Suite #200  
Montréal (QC), Canada H2P 1H4  
Tel : 514.385.3515 Fax : 514.385.4169  
www.eurekalingting.com



4255-UCR

# ANATOMIE

BIM

DIM

IES

LED

SKIRT

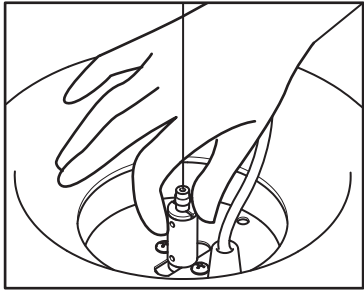

**REFLECTEUR PARABOLIQUE**  
Aluminium repoussé 16Ga  
Peinture blanche en poudre

**UN CABLE D'ACIER**  
Adjustable en chantier

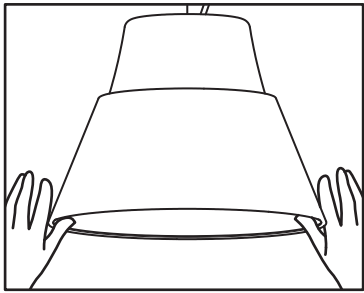
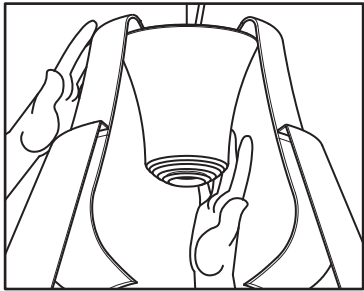

**VERSIONS DEL 4W et 8W**  
Radiateur en aluminium machiné  
avec unité d'alimentation intégrée

**SECTION DU BAS GIVRÉE**  
Surface du dessous traitée au sable  
pour minimiser l'éblouissement

**ABAT-JOUR D'ALUMINIUM REPOUSSÉ**  
Les angles bruts contrastent avec les douces  
courbes du verre Feuille d'aluminium de 16Ga

**VERSION DEL 18W (HO)**  
DEL COB avec diffuseur  
sphérique de haute efficacité

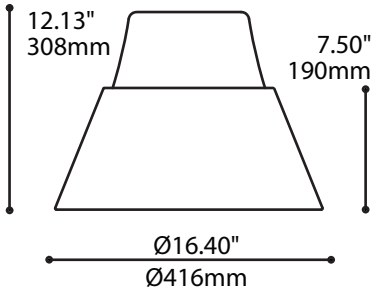

4255-UFL (BARE)



4255-UCR (SKIRT)

## SPÉCIFICATIONS

SOURCE LUMINEUSE  
LUMENS RÉELS  
IRC  
ALIMENTATION  
GRADATION  
LM-79  
GARANTIE

### LED 4W

4x DEL haute intensité (total 4.7W)  
478lm (4000K)  
84 IRC (typique)  
CC 350mA  
Gradation de type Phase (DP) ou 0-10V (DV)  
Sur demande  
5 ans

### LED 8W

4x DEL haute intensité (total 9.8W)  
875lm (4000K)

### LED 18W

1x DEL COB (total 18W)  
1304lm (4000K)

## SPÉCIFICATIONS

SOURCE LUMINEUSE  
GRADATION  
VOLTAGE

### INCANDESCENT

A19, T10 100W  
Toujours  
120V



225 de Liège Ouest, Suite #200  
Montréal (QC), Canada H2P 1H4  
Tel : 514.385.3515 Fax : 514.385.4169  
www.eurekalingting.com



4255-UCR