

POINT 2044

PROJECT PROJET
SPEC TYPE
NOTES



OVERALL HEIGHT HAUTEUR HORS TOUT

LIGHT SOURCE	LED 8W TRACK 1 CIRCUIT	LED TRACK 1 CIRCUIT	LED *	LED DIM * & 8W 277V *
MOUNTING	2734B	2734E	2401C	2403G
STEM	44.75"	46.45"	43.95"	44.95"

*FOR NO STEM / STEM ≤ 12IN - CANOPY 2401C + ACCESSORY 3983

MOUNTING OPTIONS OPTIONS DE MONTAGE

2734B	2734E	2401C	2403G
1.46" x 1.36" 37 x 35mm	6.15" x 2.00" 156 x 51mm	Ø4.50" x 0.50" Ø114 x 13mm	Ø4.50" x 1.50" Ø114 x 38mm

* OVERALL HEIGHT DOES NOT INCLUDE TRACK THICKNESS

STEM OPTIONS OPTIONS DE TIGE

STEM
STD 36" 914mm

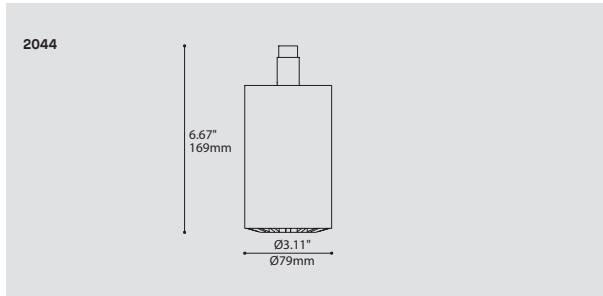

ORDERING SPECIFICATION SPÉCIFICATION DE COMMANDE	CODE
MODEL MODÈLE	2044
2044	POINT (PROJECTOR HEAD)
LIGHT SOURCE SOURCE LUMINEUSE	
(WATTAGE, LAMP TYPE, OTHER INFO)	
LED.8	8W, LED
LED.11	11W, LED
LED.18	18W, LED
COLOR TEMPERATURE TEMPÉRATURE DE COULEUR	
27	2700K
30	3000K
35	3500K
40*	4000K
*LONGER LEAD TIME MAY APPLY. PLEASE CONTACT YOUR EUREKA REPRESENTATIVE	
COLOR RENDERING INDEX (CRI) INDICE DE RENDU DE COULEUR (IRC)	
90*	90+ CRI *MANDATORY FOR 8W
ANGLE BEAM ANGLE DE DIFFUSION	
LED.8	
17	17°
48	48°
LED.11, LED.18	
20	20°
40	40°
VOLTAGE VOLTAGE	
120V	120 VOLT
277V*	277 VOLT
*NOT AVAILABLE WITH A TRACK ADAPTOR	
DIMMING OPTION OPTION DE GRADATION	
DV*	0-10V DIMMING (120-277V)
DP	PHASE DIMMING (120V ONLY)
LED DIMMING DRIVER IS STANDARD FOR 11W & 18W, PLEASE SPECIFY YOUR DIMMING TYPE. *NOT AVAILABLE WITH A TRACK ADAPTOR	
STEM TIGE	
S10	3/8" (10MM) STEM, NOT FIELD ADJUSTABLE
-	NO STEM
STEM LENGTH LONGUEUR DE TIGE	
36	36" STEM (STD LENGTH)
**	CUSTOM STEM LENGTH (PLEASE SPECIFY)*
FOR OVERALL LENGTH PLEASE CONTACT YOUR EUREKA REPRESENTATIVE. *3983 ACCESSORY PROVIDED FOR STEM/CABLE ≤ 12", EXCEPT LED 8W 120V NON-DIMMING	
MOUNTING MONTAGE	
RC*	ROUND CANOPY / PAVILLON ROND FOR LED 8W 120V NON-DIMMING & STEM/CABLE ≤ 12": 0.50" CANOPY (2401C) FOR DIMMING LED, LED 8W 277V: 1.75" CANOPY (2403G) *CANOPY FINISH ALWAYS CHROME
TA1	TRACK ADAPTOR / ADAPTATEUR DE RAIL 1 CIRCUIT LED 120V ADAPTOR (2734B) (FOR LED 8W NON-DIMMING ONLY) LED DIMMING 120V ADAPTOR (2734E)
MOUNTING OPTION OPTION DE MONTAGE	
SCA*	SLOPE CEILING ADAPTOR / ADAPTATEUR DE PLAFOND EN PENTE (ROTATION: 350°, PIVOT: 90°) *ONLY AVAILABLE WITH A STEM
TRACK ADAPTOR FINISH FINI ADAPTATEUR DE RAIL^(A)	
WH	WHITE
BLK	BLACK
M G	METALLIC GRAY (2734B ONLY)
^(A) FILL IN IF A TRACK ADAPTOR IS SELECTED, OTHERWISE LEAVE EMPTY	
STRUCTURE FINISH FINI STRUCTURE	CHR
CHR	CHROME
CYLINDER FINISH FINI CYLINDRE	
BLKA	BLACK ANODIZED
S A	SATIN ALUMINUM
WHE	WHITE FINE TEXTURE
HEATSINK FINISH FINI RADIATEUR	BLKA
BLKA	BLACK ANODIZED
ACCESSORY ACCESSOIRE	
3983	DEEP JUNCTION BOX (PROVIDED FOR STEM ≤ 12" AS PER ABOVE)

PRODUCT CHARACTERISTICS CARACTÉRISTIQUES DU PRODUIT



ANATOMY

BIM

DIM

IES

LED

2044
2044B
350°

2044
2044B
60°

POINT

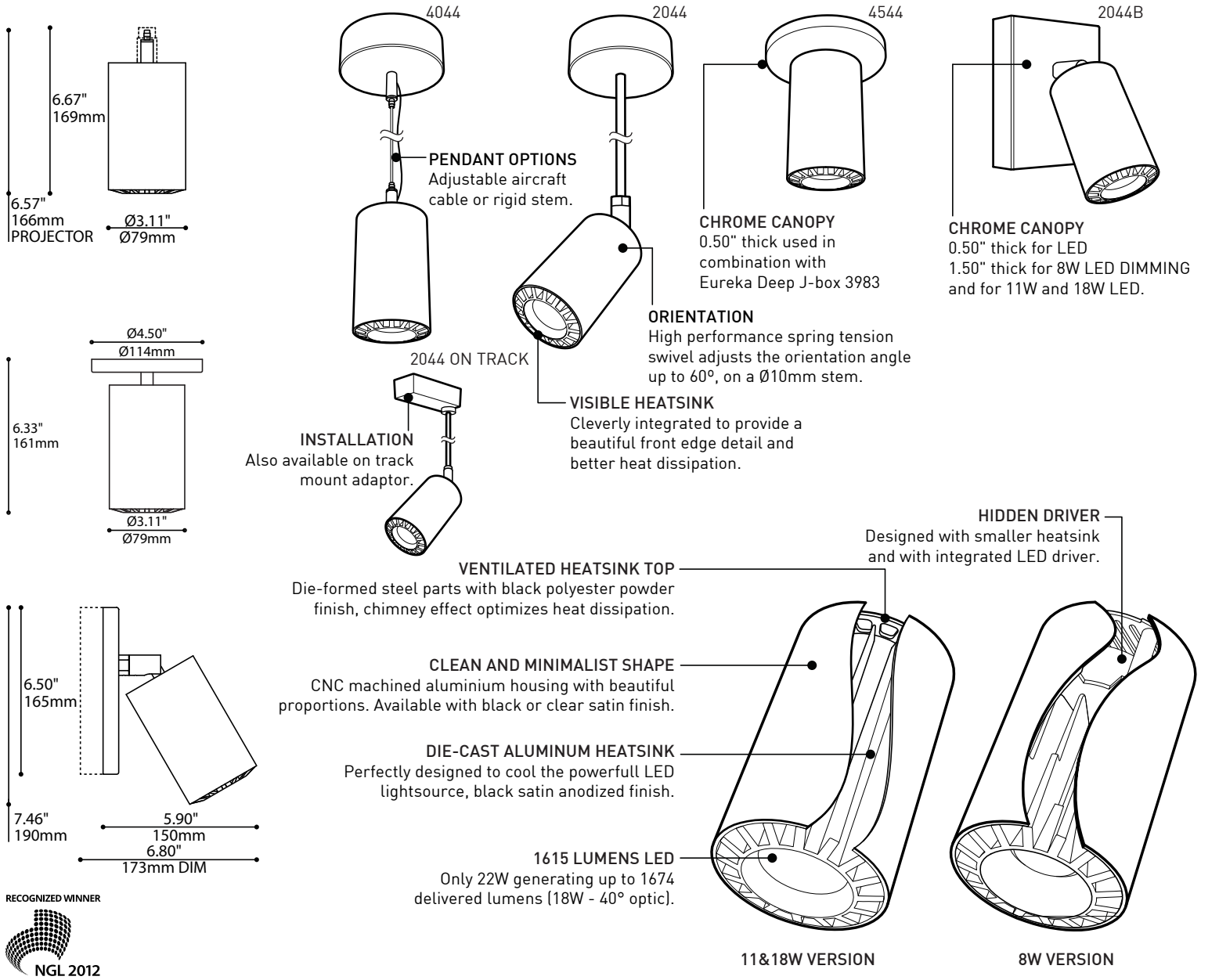

SPECIFICATIONS

	8W LED	11W LED	18W LED
LIGHT SOURCE	4 LED on MCPCB - System wattage 10W Total	1 x COB LED - System wattage 15W Total	1 x COB LED - System wattage 22W Total
DELIVERED LUMENS	964 lm	1438 lm [40° optic] or 1457 lm [20° optic]	1858 lm [40° optic] or 1882 lm [20° optic]
CRI	80 CRI (typical)		
CCT	3-step MacAdam Ellipse binning		
HOUSING	Machined aluminium tube		
HEATSINK	Black anodized aluminum		
LIGHT DISTRIBUTION	Directional (2044/2044B) or Direct (4044/4544)		
OPTICS	Total Internal Reflection (TIR) - 17° & 48°	TIR - 20° & 40°	TIR - 20° & 40°
VOLTAGE	120V or 277V	120V (DP) and 120-277V (DV)	120V (DP) and 120-277V (DV)
DRIVER	Constant Current 700mA, UL Recognized	Constant Current 350mA, UL Recognized	Constant Current 500mA, UL Recognized
DIMMING	Phase Dimming (DP) and 0-10V Dimming (DV)		
LM-79	On request	On request	On request
WARRANTY	5 years		



225 de Liège Ouest, Suite #200
Montréal (QC), Canada H2P 1H4
Tel : 514.385.3515 Fax : 514.385.4169
www.eurekalighting.com



2044 4044
2044B 4544

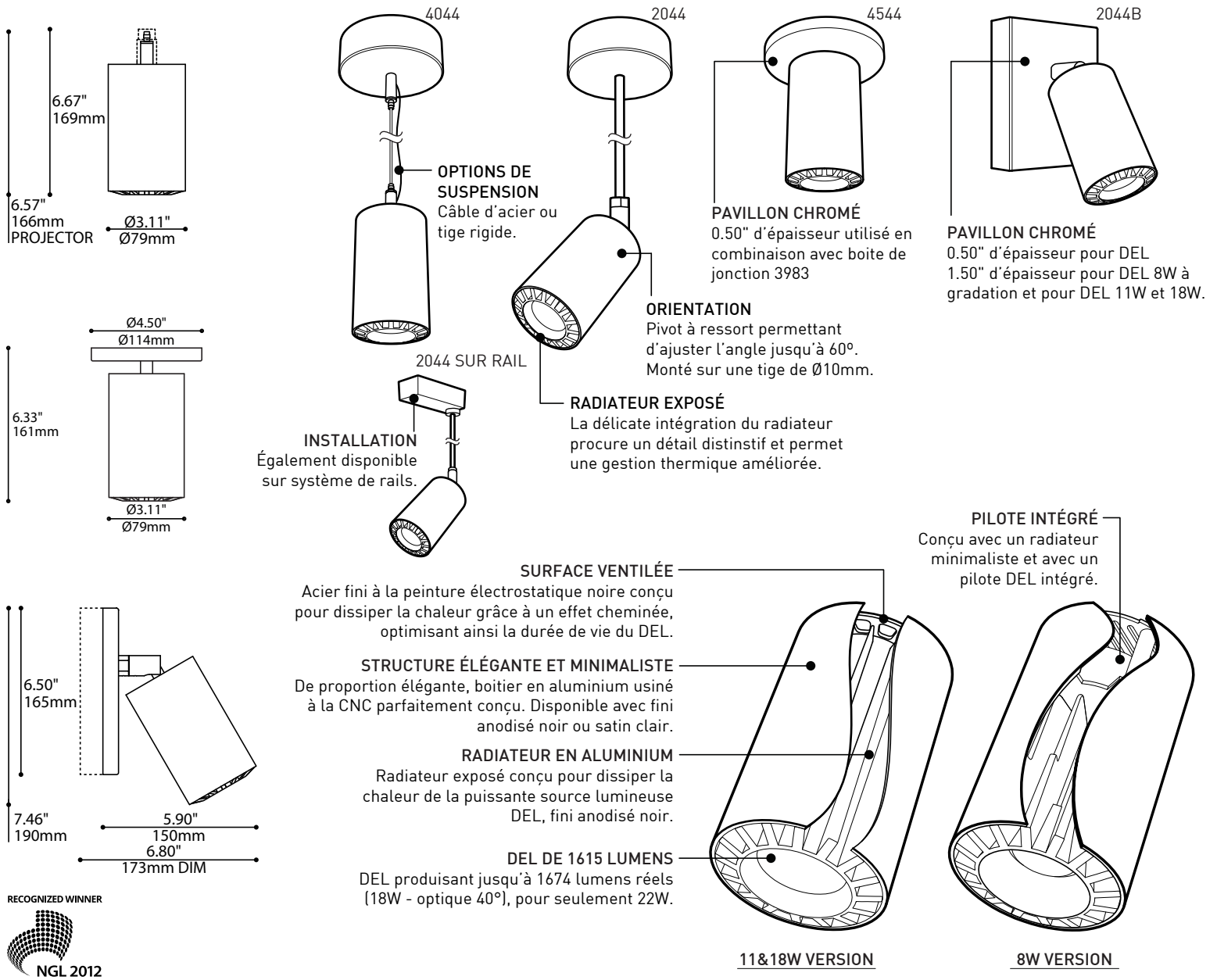

SPECIFICATIONS

	DEL 8W	DEL 11W	DEL 18W
SOURCE LUMINEUSE	4 LED sur MCPCB - Puissance totale de 10W	1 DEL "COB" - Puissance totale de 15W	1 DEL "COB" - Puissance totale 22W
LUMENS RÉELS	964lm	1438lm (optique 40°) ou 1457 lm (20°)	1858 lm (optique 40°) ou 1882 lm (20°)
IRC	80 CRI (typique)		
CCT	3-step MacAdam Ellipse binning		
BOÎTIER	Tube d'aluminium usiné		
RADIATEUR	Aluminium anodisé noir		
DISTRIBUTION LUMINEUSE	Directionnel (2044/2044B) ou direct (4044/4544)		
OPTIQUES	17° & 48° Reflection Totale Interne (TIR)	Faisceaux de 20° & 40° "TIR"	Faisceaux de 20° & 40° "TIR"
VOLTAGE	120V ou 277V	120V (DP) et 120-277V (DV)	120V (DP) et 120-277V (DV)
PILOTE	Courant Constant 700mA, Reconnu UL	Courant Constant 350mA, Reconnu UL	Courant Constant 500mA, Reconnu UL
GRADATION	DP "phase dimming" et DV "0-10V dimming"		
LM-79	Sur demande	Sur demande	Sur demande
GARANTIE	5 ans		